

Planter made of steel finished in marson colour, designed to last over time without maintenance.
No finish needed, thus eliminating processes that pollute the environment and contributing to sustainability.

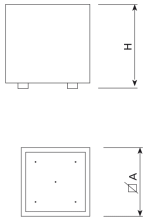

Ref.	A	B	H
UM1160M	Ø 750	-	750
UM1220M	750	750	750



[Project sheet](#) | [BIM](#) | [HD image](#)

Planter made of steel finished in marson colour, designed to last over time without maintenance.
No finish needed, thus eliminating processes that pollute the environment and contributing to sustainability.

Available in:



Epoxy primer finish and Corten
Color polyester powder paint
(UM1220).



BENITO

info@benito.com
tel. 93 852 1000