



## PROJECT

PROJ-100-2021

Surface: 385 m<sup>2</sup>

Email: [info@benito.com](mailto:info@benito.com)

Telephone: +34 93 852 1000

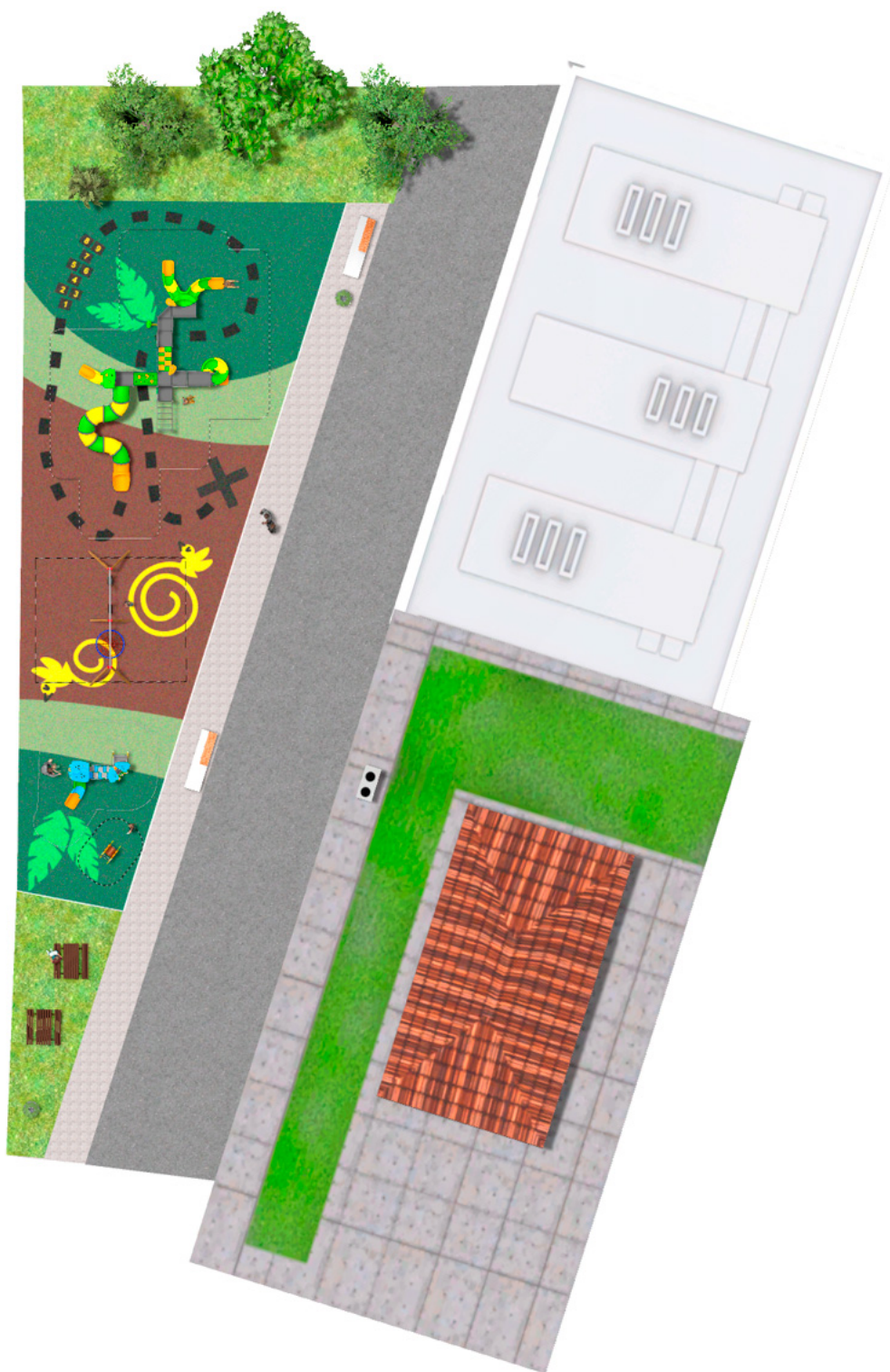



# BENITO

—Playground Equipment

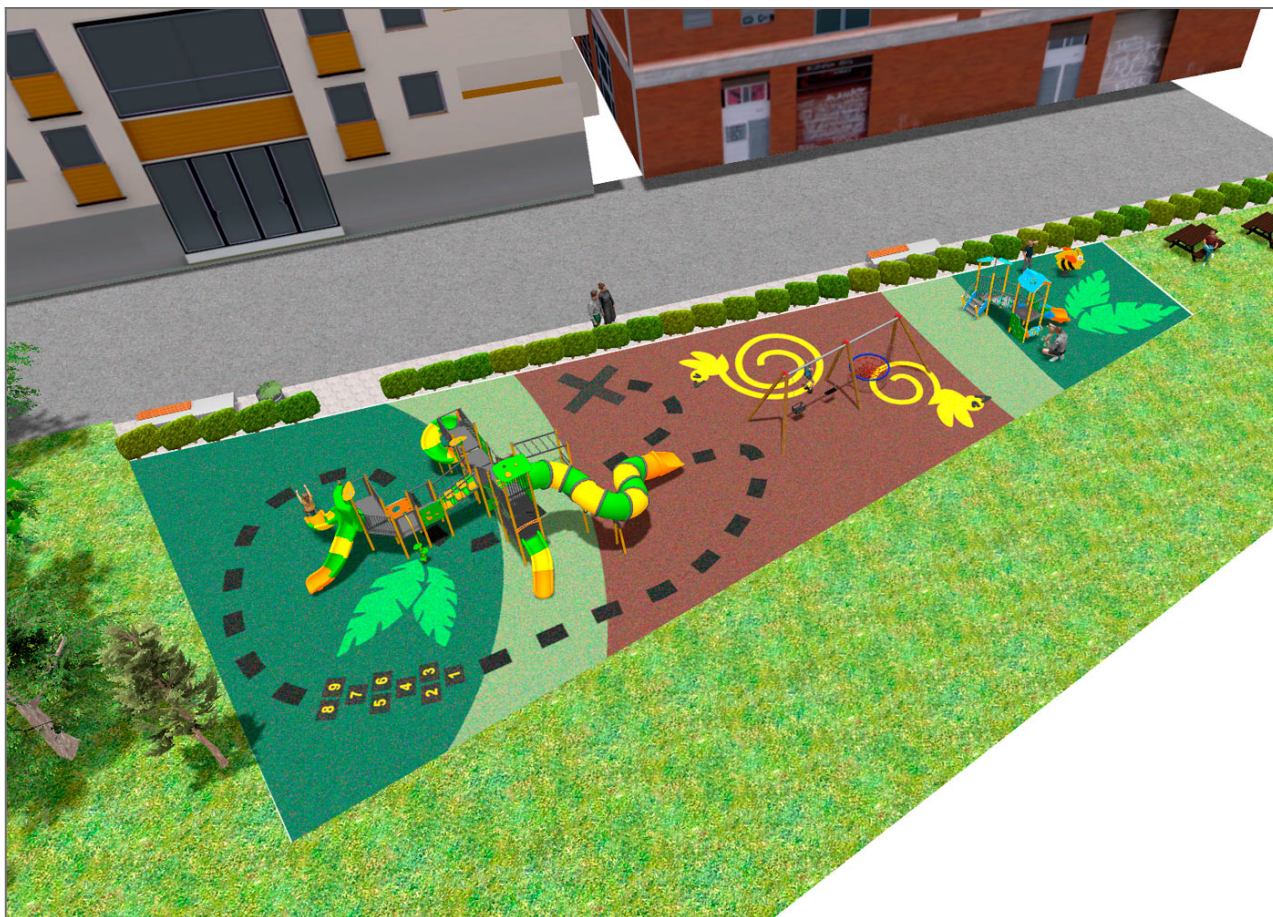







# BENITO

-Playground Equipment





Product	Description
JALU04 	<b>Alu 4</b> The ALU collection <b>maximises playability</b> . Including lots of slides, bridges and dynamic elements, the ALU line encourages children to play, even those with disabilities. Its bright colours don't go unnoticed and the quality of materials guarantee high durability.parts.  <a href="#">Data Sheet</a> <a href="#">Acreditative Letter</a> <a href="#">Certificate Conformity</a>
JALU10 	<b>Elix</b> The ALU collection <b>maximises playability</b> . Including lots of slides, bridges and dynamic elements, the ALU line encourages children to play, even those with disabilities. Its bright colours don't go unnoticed and the quality of materials guarantee high durability.  <a href="#">Data Sheet</a>
JL2311010 	<b>Combo 6</b> Swings for children made of different materials such as wood and steel. Resistant to abrasion, corrosion and bad weather conditions.  <a href="#">Data Sheet</a> <a href="#">Certificate</a> <a href="#">Certificate Conformity</a>
JFS08 	<b>Maia</b> Fun and educative spring swing for children. Made of resistant materials according to the EN1176 standard.  <a href="#">Data Sheet</a> <a href="#">Certificate</a> <a href="#">Certificate Conformity</a>