

# BENITO

–Playground Equipment

## BENITO

- Urban
- Light
- Play
- Covers

Vista en perspectiva



## PROJECT

PROJ-053-2023

Surface: 150 m<sup>2</sup>

Email: [info@benito.com](mailto:info@benito.com)

Telephone: +34 93 852 1000

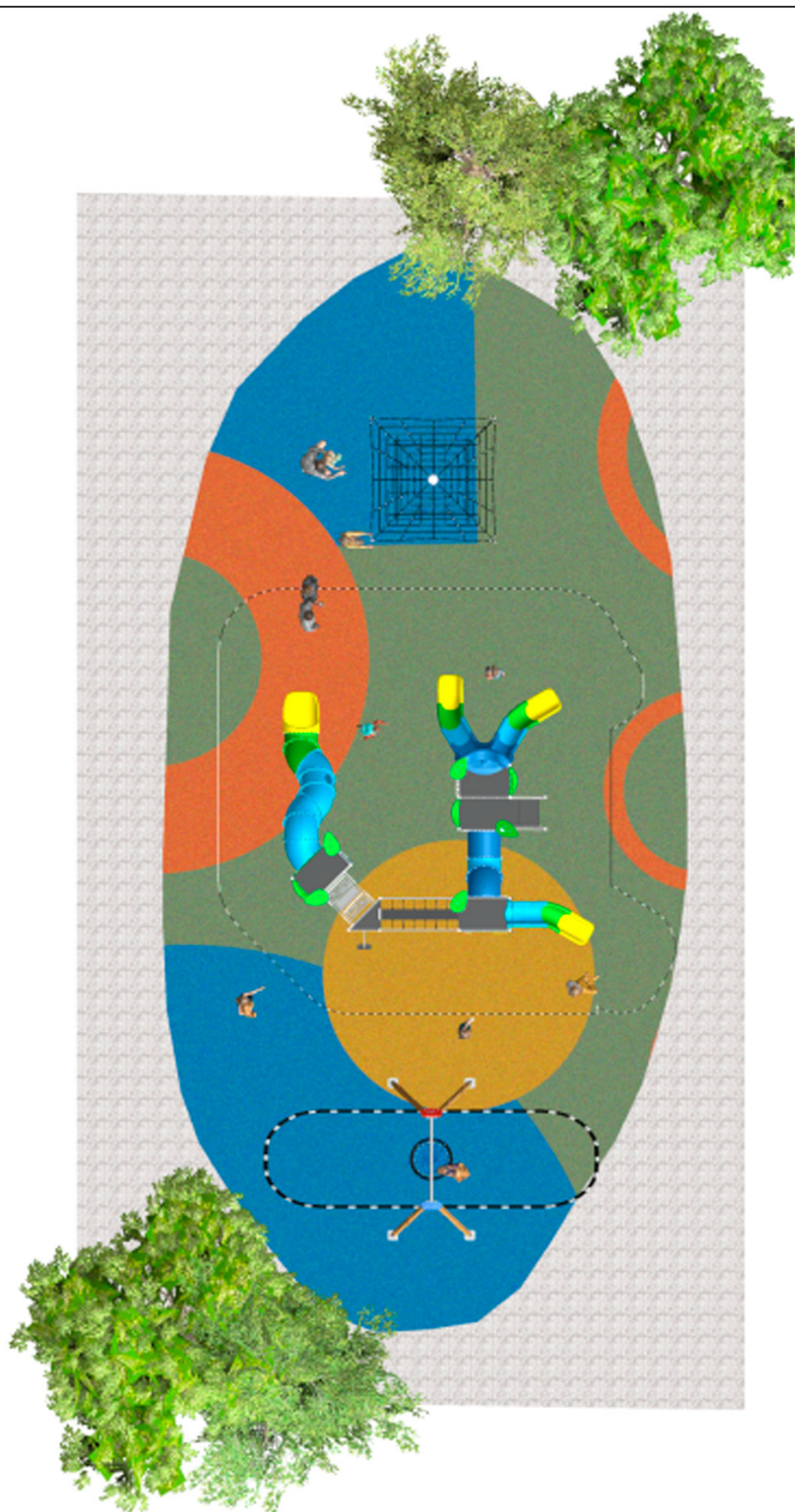



# BENITO

—Playground Equipment





# BENITO

—Playground Equipment

## BENITO

- Urban
- Light
- Play
- Covers

Vista en perspectiva







# BENITO

–Playground Equipment

**BENITO**  
–Urban  
–Light  
–Play  
–Covers

Vista en perspectiva



Product	Description
<p>JALU06</p> 	<p><b>Alu 6</b> The ALU collection <b>maximises playability</b>. Including lots of slides, bridges and dynamic elements, the ALU line encourages children to play, even those with disabilities. Its bright colours don't go unnoticed and the quality of materials guarantee high durability.</p> <p><a href="#">Data Sheet</a> <a href="#">Acreditative Letter</a> <a href="#">Certificate Conformity</a></p>
<p>JL1500010</p> 	<p><b>MADERA 1 Nest</b> Swings for children made of different materials such as wood and steel. Resistant to abrasion, corrosion and bad weather conditions.</p> <p><a href="#">Data Sheet</a> <a href="#">Certificate</a> <a href="#">Certificate Conformity</a></p>
<p>JPVRM25</p> 	<p><b>Metric 2,5</b> <b>Structure, Metal:</b> hot-dip galvanised steel poles are the centre of the fundamental structure of 3D nets. Their main function is to stabilise the rocking of the product and support heavy loads from several axis.</p> <p><a href="#">Data Sheet</a> <a href="#">Acreditative Letter</a> <a href="#">Certificate Conformity</a></p>